



## Taizhou JiaoGuang Lighting Co., Ltd.

1 Wei Er Road, Taizhou City, Zhejiang Province, China 318000

Tel:+86-576-89086611 Fax:+86-576-89086658

E-mail: salesdept9@jiaoguang.com; www.jiaoguang.com

## LED Troffer



### TR14W2

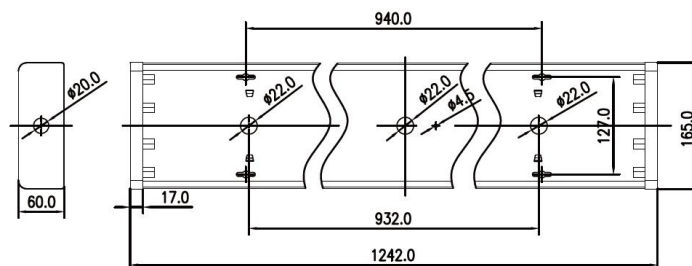

Size : 30x120cm(11.81x47.24")

### Characteristics

Item Number	TR14W2
Description	1'x4' LED Troffer
Voltage	110-277V AC
Power	36W
T8 tube light	2 of T8 tubes(RG114)
LED Type	SMD
CRI	>80
Lumens	3200 lms
Color	2700-6000K
Life time	50,000 hours
Certificate	cULus Approved

### Features

- Energy efficient: save up to 80% in energy costs
- High lumen output
- Mercury-free
- UL certified to US and Canadian standards.
- Listed for damp locations.
- Instant-on light
- 50,000 hours at 70% lumen maintenance rated life
- CCT:2700-6000K
- 3 years manufacturer warranty

### Application

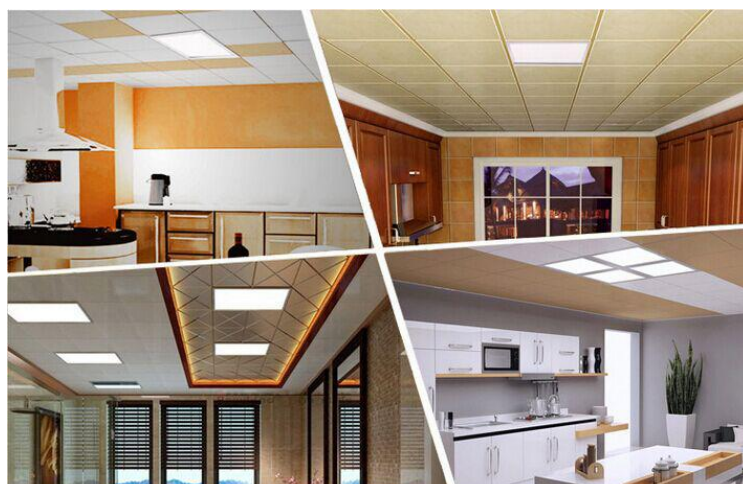



## Taizhou JiaoGuang Lighting Co., Ltd.

1 Wei Er Road, Taizhou City, Zhejiang Province, China 318000

Tel:+86-576-89086611 Fax:+86-576-89086658

E-mail: salesdept9@jiaoguang.com; www.jiaoguang.com

### Easy to Install in Steps:

Lift fixture housing to the ceiling, positioning the center knockout of the housing over the junction box and parallel to the ceiling.

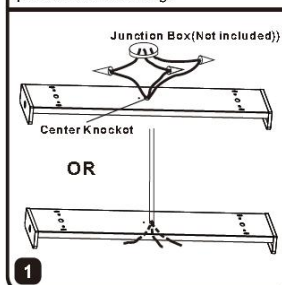

Mark ceiling with a pencil for the drill hole locations through the narrow portion on the 4 keyhole slots.

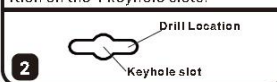

Drill 1/8" pilot hole at each location

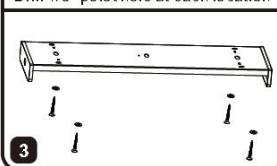

If drill encounters ceiling joist, use wood screws (provided) & washers (not included) to secure fixture housing to the ceiling.

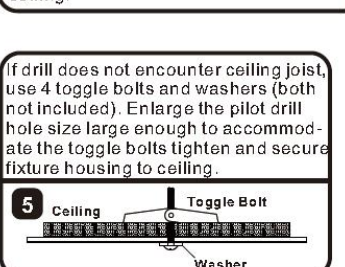

If drill does not encounter ceiling joist, use 4 toggle bolts and washers (both not included). Enlarge the pilot drill hole size large enough to accommodate the toggle bolts tighten and secure fixture housing to ceiling.

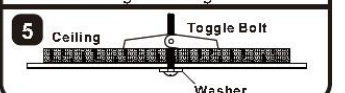

Reinforce the mounting of the housing to the ceiling by adding a board between the expansion part of the toggle bolt and the ceiling tile.

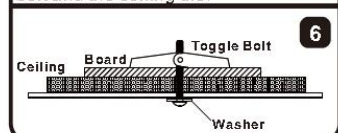

## WIRING OF THE LIGHT FIXTURE

Connect the black supply wire to the black wire from the light fixture.  
Connect the white supply wire to the white wire from the light fixture.  
Connect the bare or green supply wire to the green wire from the light fixture.

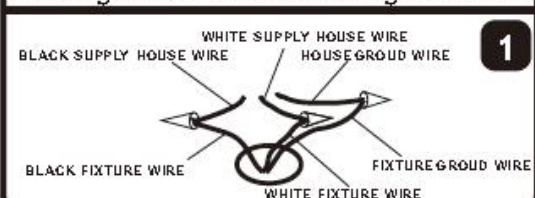

Squeeze wireway cover at both ends on both sides to release from the fixture housing and install the expansion. **THE FIXTURE SHOULD NOT BE OPERATED WITHOUT THE WIRWAY COVER IN PLACE**

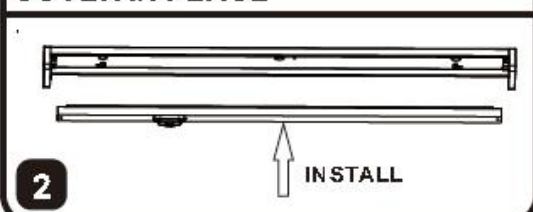

Installing LED tube into fixture and making one side marked "AC INPUT" which connects holder with the power supply, insert the complete tube inside the housing and then carefully straighten the lamp until it lines up parallel under lampholder. Insert the pins located on both ends of the tube up into the lampholder. Rotate the lamp approx 1/4 turn until a "clip" or "snap" is felt.

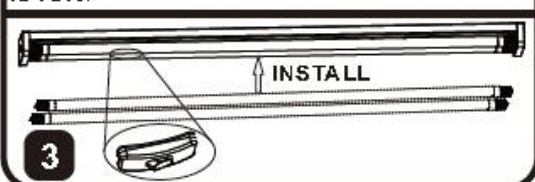

Turn on the switch in the fixture and replace the lens by reversing the steps as described on page 2, point 1. **BE EXTREMELY CAREFUL WHEN REPLACING THE LENS BACK ON THE LIGHT FIXTURE TO AVOID POSSIBLE DAMAGE TO THE LENS.**

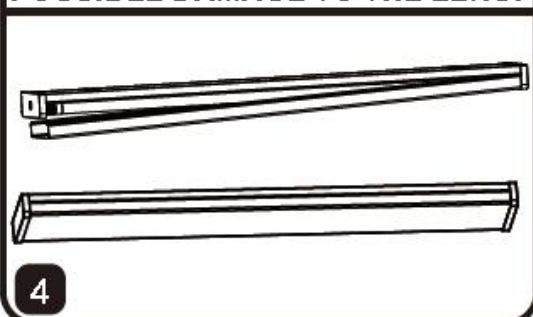





## Taizhou JiaoGuang Lighting Co., Ltd.

1 Wei Er Road, Taizhou City, Zhejiang Province, China 318000

Tel:+86-576-89086611 Fax:+86-576-89086658

E-mail: salesdept9@jiaoguang.com; www.jiaoguang.com

### Packaging

Item	Carton Size	Pcs/CTN	N.W.	G.W.
TR14W2	125.5x38.5x18cm/49.41x15.16x7.09"	6	18.5kgs/40.79 lb	19.6kgs/43.21lb

### Production & Facilities

